



ELECTRONIC HOOK SWITCH (EHS) SOLUTIONS FOR CISCO



SUPPORTED CISCO IP PHONES



Cisco Unified IP Phone 7942G
 Cisco Unified IP Phone 7945G
 Cisco Unified IP Phone 7962G
 Cisco Unified IP Phone 7965G¹
 Cisco Unified IP Phone 7975G¹



Cisco Unified IP Phone 8961
 Cisco Unified IP Phone 9951
 Cisco Unified IP Phone 9971



Cisco Unified IP Phone 8945
 Cisco Unified IP Phone 9951
 Cisco Unified IP Phone 9971
 Cisco CUIS



Jabra LINK™ 14201-222 EHS Adapter²



Jabra LINK™ 14201-16 EHS Adapter^{2,3}



Jabra LINK™ 14201-30 EHS Adapter^{2,3}



Bluetooth connection



Jabra PRO™ 9400 Series⁴



Jabra PRO™ 920



Jabra GO™ 6470⁵



Jabra GN9350e/
Jabra GN9330e⁶



Jabra GN9120 EHS⁷/
Jabra GN9125



Jabra PRO™ 9400 Series⁴

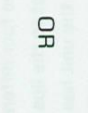

Jabra PRO™ 920



Jabra GN9350e



Jabra GO 6470



Jabra GO™ 6430



Jabra GO 660

Note: Headset Hookswitch Control must be enabled on each phone.

¹ EHS also possible via Cisco 7915IP extension panel

² The Jabra PRO 9400 Series, Jabra GO 6470, Jabra GN9300e Series, Jabra GN9120 Series

³ Jabra LINK™ 14201-16 and Jabra LINK™ 14201-30 are not compatible with the listed Cisco Unified IP phones

⁴ HFC requires Cisco Unified Communications Manager 4.1(3) service release 6 or above plus the 8.3(3) phone firmware load

⁵ Required software version, Value Pack 2 - can be downloaded via Jabra PC Suite

SET UP INFORMATION

To connect your Cisco Unified IP Phone and Jabra headset with the Jabra EHS Adapter, just follow these simple steps:

- ### SETTING UP THE CISCO UNIFIED IP PHONE
1. Connect the larger plug to the AUX port on the phone.
 2. Connect the smaller plug to the AUX port on the headset base.
 3. Connect the normal audio cable to the headset socket on the phone and the phone socket on the headset base.
 4. Ensure compatibility selector setting on headset base is set to "B" and EHS setting is set to DSHG. Set to CISCO on Jabra PRO 9400 Series and Jabra GO 6470 Series.

- ### SETTING UP THE CISCO UNIFIED IP PHONE 9971, 9951/8961
1. Set compatibility selector on headset base to position "A" with DSHG on headset. Set to CISCO on Jabra PRO 9400 Series and Jabra GO 6470 Series.
 2. Connect via USB to side port of phone
 3. Connection should read: The Jabra LINK™ 14201-30 is now connected.
 4. Confirm by going to Setup>Accessories in the phone. You should see the Jabra LINK™ 14201-30 as a Device Type: Peripheral/ Device Class: Audio/Configured: Yes

Setting up Jabra PRO™ 9400 and Jabra GO™ 6470 – follow the guide on page 31.

- ### SETTING UP JABRA PRO™ 920
1. Connect the Jabra LINK™ adapter as shown in adapter documentation supplied with the Jabra LINK™. On some phones the telephone cable will also need to be connected.
 2. Call your connected desk phone using another phone to enable the Jabra LINK™ adapter. Wait 10 seconds before answering.
 3. Set a clear dial tone. Locate the clear dial tone switch on the back of the Jabra PRO 920 base and rotate to "A".
 4. Set the Microphone volume. Make a call to test your speaking volume. The listener should not adjust their own volume. You may adjust your microphone speaking volume using the + / - volume buttons.

- ### SETTING UP JABRA GN9350E
1. Open up the cover on the base unit.
 2. On the LCD display, navigate to the handset picture.
 3. Navigate to the DSHG mode and select it by pressing the OK button.
 4. Set Compatibility selector in position "B".

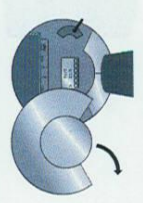

Compatibility selector Jabra GN9350E

- ### SETTING UP JABRA GN9330E
1. Place the headset in the base with its indicators facing you.
 2. Press the Telephone button on the Base for 6 seconds while the headset is in the base until the headset's blue LED is flashing rapidly.
 3. Use the volume up/down button to shift between the different EHS settings – see table below.

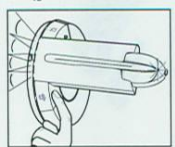

The base unit's 4 battery indicators show which EHS mode the Jabra GN9330E is in.

GN PHL (Default)	DSHG	AEI	MSH

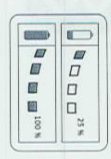

Note: If more than 15 seconds elapse without pressing the volume + or volume - button, the last selected interface will be activated.

4. Set the base unit to the DSHG mode.
5. To set the EHS mode, press the Telephone button on the Base for 6 seconds until the 4 battery indicators flash once. Now wait 5 seconds and the headset is initialized.
6. Set Compatibility selector in position "B".

- ### SETTING UP JABRA GN9120 EHS/ JABRA GN9125
1. Set compatibility selector (Telephone Termination Switch Wheel) in position "B".
 2. Set the base unit to the DSHG mode by keeping the headset in the base and hold the volume + / - buttons on the headset for 6 seconds until the red light on the base flashes rapidly.
 3. Scroll through the four different settings using + / - and set to the lips icon. Leave for 15 seconds until the unit has displayed the confirmation flash sequence and it is ready to go!

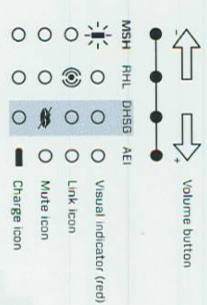

- ### SETTING UP JABRA GO™ 660
1. Turn headset on.
 2. Press and hold answer/end button until solid blue light comes on.
 3. Activate Bluetooth on your phone.
 4. Search for Bluetooth devices and select Jabra EXTREME.
 5. Press "OK" on the phone and confirm with PIN code 0000 (4 zeros).