



# ELECTRONIC HOOK SWITCH (EHS) SOLUTIONS FOR ALCATEL-LUCENT



## SUPPORTED ALCATEL-LUCENT IP PHONES



Alcatel 8-Series (IP)  
IP Touch 4028 EE  
IP Touch 4038 EE  
IP Touch 4068 EE



Alcatel 8-Series (IP)  
IP Touch 4028<sup>1</sup>  
IP Touch 4038<sup>1</sup>  
IP Touch 4068



Alcatel 9-Series (UA)  
4029  
4039



Jabra LINK™ 14201-20 EHS Adapter



Jabra LINK™ 14201-09 EHS Adapter



Jabra PRO™ 9400 Series

OR



Jabra GO™ 6470

OR



Jabra PRO™ 920

OR

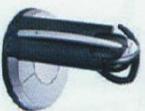

Jabra GN9350e/  
Jabra GN9330e

OR



Jabra GN9120 EHS<sup>2</sup>/  
Jabra GN9125<sup>2</sup>

<sup>1</sup> "Silent Mode" or "Progressive Ringing" must not be selected on the telephone  
<sup>2</sup> MSH enabled model. Jabra GN9125 is not compatible with MSH mode

# SET UP INFORMATION

To connect your Alcatel-Lucent phone and Jabra headset with the MSH 14201-09 cable, just follow these simple steps:



Jabra headset base and Alcatel 8+9 Series.

**Setting up Jabra PRO™ 9400 and Jabra GO™ 6470 - follow the guide on page 31.**

## SETTING UP JABRA PRO™ 920

1. Connect the Jabra LINK™ adapter as shown in adapter documentation supplied with the Jabra LINK™. On some phones the telephone cable will also need to be connected.
2. Call your connected desk phone using another phone to enable the Jabra LINK™ adapter. Wait 10 seconds before answering.
3. Set a clear dial tone. Locate the clear dial tone switch on the back of the Jabra PRO 920 base and rotate to "A".
4. Set the Microphone volume. Make a call to test your speaking volume. The listener should not adjust their own volume. You may adjust your microphone speaking volume using the + / - volume buttons.

## SETTING UP JABRA GN9350E

1. Open up the cover on the base unit.
2. On the LCD display, navigate to the handset picture.
3. Navigate to the MSH mode and select it by pressing the OK button.

<sup>1</sup> Cable included in headset pack

4. Set Compatibility selector in position "A".

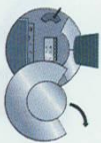

Compatibility selector  
Jabra GN9350E

## SETTING UP JABRA GN9330E

1. Place the headset in the base with its indicators facing you.
2. Press the Telephone button on the Base for 6 seconds while the headset is in the base until the headset's blue LED is flashing rapidly.
3. Use the volume up/down button to shift between the different EHS settings - see table below.

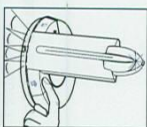

The base unit's 4 battery indicators show which EHS mode the Jabra GN9330E is in.

GN RHL (default)	DHSG	AEI	MSH
<input type="checkbox"/>	<input type="checkbox"/>	<input type="checkbox"/>	<input type="checkbox"/>
<input type="checkbox"/>	<input type="checkbox"/>	<input type="checkbox"/>	<input type="checkbox"/>
<input type="checkbox"/>	<input type="checkbox"/>	<input type="checkbox"/>	<input type="checkbox"/>
<input type="checkbox"/>	<input type="checkbox"/>	<input type="checkbox"/>	<input type="checkbox"/>

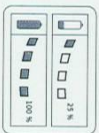

Note: If more than 15 seconds elapse without pressing the volume + or volume - button, the last selected interface will be activated.

4. Set the base unit to the MSH mode.
5. To set the EHS mode, press the Telephone button on the Base for 6 seconds until the 4 battery indicators flash once. Now wait 5 seconds and the headset is initialized.
6. Set Compatibility selector in position "A".

## SETTING UP JABRA GN9120 EHS/

### JABRA GN9125

1. Set compatibility selector (Telephone Termination Switch Wheel) in position "A".
2. Set the base unit to the MSH mode by keeping the headset in the base and hold the volume + / - buttons on the headset for 6 seconds until the red light on the base flashes rapidly.
3. Scroll through the four different settings using + / - and set to the lips icon. Leave for 15 seconds until the unit has displayed the confirmation flash sequence and it is ready to go!



MSH	<input type="radio"/>	Visual indicator (red)
RHL	<input type="radio"/>	Link icon
DHSG	<input type="radio"/>	Mute icon
AEI	<input type="radio"/>	Charge icon

## TO INSTALL YOUR JABRA LINK™ 14201-20 EHS ADAPTER WITH YOUR ALCATEL PHONE SETTINGS

1. Install your headset solution to your desk phone according to the headset manual.
2. Set "Clear dial tone switch" in "A" position - see headset manual.
3. Ensure your headset base unit EHS mode is set up to DHSG - see headset manual\*.

## CONNECTIONS

4. With the cable included with your headset system, connect the phone socket on your headset base unit to the phone socket on your Jabra LINK™ EHS Adapter.

5. With the cable marked white D, connect the Headset / Handset socket on your Jabra LINK™ EHS Adapter to the 3.5 mm headset socket on the side of your desk phone.
6. With the cable marked orange A, connect the COM socket on your Jabra LINK™ EHS Adapter to the modular socket on your desk phone marked with a "Bell" icon.
7. With the cable marked red, connect the AUX socket on your headset base unit to the Jabra LINK™ EHS Adapter AUX socket.

ALCATEL CABLES	
EE4028	- Cable marked: D White
EE4038	- Cable marked: Red
EE4068	- Cable marked: A Orange - Telephone cord

Note: The marked end of each cable must be connected to the Jabra LINK™ EHS adapter.

## USING DICTAPHONE OUTPUT

The dictaphone output can be used to record a conversation in both directions. A 2.5 mm jack to 3.5 mm jack cable is not included but can be ordered as an accessory (Part Number 14201-21).

## CLEANING THE JABRA LINK™ EHS ADAPTER

Only use a soft - and, if necessary, slightly damp - cloth for cleaning the Jabra LINK™ EHS Adapter. Do not use any solvents or cleansing agents as these can damage the finish of the Jabra LINK™ EHS Adapter.