

SUPPORTED AASTRA IP PHONES



Aastra 6771
Aastra 6773/1p
Aastra 6775/1p



Aastra 7434ip
Aastra 7444ip



Aastra 5370
Aastra 5370ip



Aastra 5380
Aastra 5380ip



Aastra 6739i¹



Aastra 6753i (S3)
Aastra 6755i (S5)



Aastra 6757i (S7)



Aastra 6757i CT (S7)
- only available in NA



Jabra LINK™ 14201-10 EHS Adapter



Jabra LINK 14201-10 EHS Adapter



Aastra DHS6 cable kit
- available from your Aastra reseller



Jabra PRO™ 9400 Series¹



Jabra GO™ 6470



Jabra PRO™ 920



Jabra GN9350e/
Jabra GN9330e



Jabra GN9120 EHS/
Jabra GN9125

ELECTRONIC HOOK SWITCH (EHS) SOLUTIONS

WITH EHS CAPABILITIES



¹ Jabra PRO 9400 Series headsets, Jabra GO 660 and Jabra GO 6430 provide EHS via Bluetooth® connection with Aastra 6739i

SET UP INFORMATION

To connect your Aastra phone and Jabra headset with the DHSG cable, just follow these simple steps:

- SETTING UP THE AASTRA IP PHONE**
1. Plug the single end of the Y cable in the headset socket on the phone's headset port.
 2. Connect the large plug in the other end to the AUX port on the headset base.
 3. Plug the smaller RJ9 in the normal phone socket on the headset base.

Setting up Jabra PRO™ 9400 and Jabra GO™ 6470 – follow the guide on page 31.

SETTING UP JABRA PRO™ 920

1. Connect the Jabra LINK™ adapter as shown in adapter documentation supplied with the Jabra LINK™. On some phones the telephone cable will also need to be connected.
2. Call your connected desk phone using another phone to enable the Jabra LINK™ adapter. Wait 10 seconds before answering.
3. Set a clear dial tone. Locate the clear dial tone switch on the back of the Jabra PRO 920 base and rotate to "A".
4. Set the Microphone volume. Make a call to test your speaking volume. The listener should not adjust their own volume. You may adjust your microphone speaking volume using the + / - volume buttons.

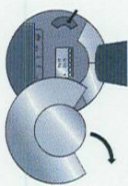

Compatibility selector
Jabra GN9330e

- SETTING UP JABRA GN9330e**
1. Open up the cover on the base unit.
 2. On the LCD display, navigate to the handset picture.
 3. Navigate to the DHSG mode and select it by pressing the OK button.
 4. Set Compatibility selector in position "A".

- SETTING UP JABRA GN9330e**
1. Place the headset in the base with its indicators facing you.
 2. Press the Telephone button on the Base for 6 seconds while the headset is in the base until the headset's blue LED is flashing rapidly.
 3. Use the volume up/down button to shift between the different EHS settings – see table below.

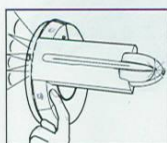

The base unit's 4 battery indicators show which EHS mode the Jabra GN9330e is in.

GN RHL (Default)	DHSG	AEI	MSH
█ □ □ □	█ █ █ █	█ □ □ □	█ □ □ □
█ □ □ □	█ █ █ █	█ □ □ □	█ □ □ □
█ □ □ □	█ █ █ █	█ □ □ □	█ □ □ █

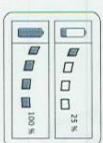

Note: If more than 15 seconds elapse without pressing the volume + or volume - button, the last selected interface will be activated.

4. Set the base unit to the DHSG mode.
5. To set the EHS mode, press the Telephone button on the Base for 6 seconds until the 4 battery indicators flash once. Now wait 5 seconds and the headset is initialized.
6. Set Compatibility selector in position "A".

SETTING UP JABRA GN9120 EHS/ JABRA GN9125

1. Set compatibility selector (Telephone Termination Switch Wheel) in position "A".
2. Set the base unit to the DHSG mode by keeping the headset in the base and hold the volume + / - buttons on the headset for 6 seconds until the red light on the base flashes rapidly.
3. Scroll through the four different settings using + / - and set to the lips icon. Leave for 15 seconds until the unit has displayed the confirmation flash sequence and it is ready to go!

